



## EXB and EIB Compact Circuit Breaker Assemblies

Spike Electric Controls and Eaton's Crouse-Hinds, presents the groundbreaking EIB Series Compact Circuit Breaker Assemblies, an innovative range of explosion-proof motor control solutions. Within this series, the EIB utilizes the ECP style D enclosure, known for its robust bolted construction, NEMA 4-rated environmental protection, and comprehensive Class I, Division 1, Group B, C, and D hazardous area certifications. The EIB series stands out as a cost-effective and efficient solution for circuit breaker protection, incorporating the reliable Cutler-Hammer Type EG circuit breakers. This comprehensive line offers circuit breaker protection across a wide range, from 15 to 1200 amps.





# EXB and EIB

Compact Circuit Breaker Assemblies



The EIB Series Compact Circuit Breaker Assemblies are an innovative line of explosion-proof motor control now being offered by Eaton's Crouse-Hinds. The EIB series utilizes the EJB style D enclosure with its bolted construction, NEMA 4 environmental protection and Class I, Division 1, Group B, C and D hazardous area ratings. The EIB series is a cost-effective solution for circuit breaker protection and utilizes the Cutler-Hammer Type EG circuit breakers. Circuit breaker protection is available from 15 to 1200 amps.

### Features:

- Small compact footprint requires less mounting space and reduces enclosure cost
- Rotary handle operator mounted on cover assembly provides clear indication of on, off and trip positions
- No internal fork operator, eliminating potential damage to breaker toggle
- Trip position easily identified from a distance
- Neoprene cover gasket provides UL Type 4 (hosetight) environmental rating
- Detachable mounting feet offer flexible mounting alternatives - no need to replace the entire enclosure if a mounting foot is broken
- Stainless steel hinges provide extreme durability and easy access to inside of enclosure for wiring and maintenance
- (2) 11 /2" NPT conduit entries, one on top and one on bottom for easy top or bottom feed of conductors. For field addition of breather and/or drain; holes come plugged
- Provides lockout/tagout capability which complies with OSHA requirements, allowing for locking in the ON or OFF

position for standard maintenance checks bending requirements for max gauge wire, allowing for easy and safe installation, and reliable operation of product

### Standard Finishes:

- Copper-free Aluminum - Natural
- Steel - Electro-galvanized

### Certifications & Compliances:

#### EXB

- Class I, Divisions 1 & 2, Groups B, C & D
- Class I, Zones 1 & 2 (ONLY EIB)
- Class II, Division 1, Groups E, F and G
- Class III
- Enclosure type 3, 3R, 4, 7BCD, 9EFG
- NEMA 3, 3R, 4, 7BCD, 9EFG
- cUL and UL Standard 1203

#### EIB Same as EXB +

- Class I, Zones 1 & 2

### Options:

- Auxiliary Contact (single block) ... S784
- Auxiliary Contacts (two blocks) ... S785
- Breather and Drain ..... S756V
- Epoxy Powder Coat Finish (external only) ..... S752
- Epoxy Powder Coat Finish (internal and external) ..... S753
- External Ground Lug ..... S214
- Red on Pilot light ..... J1
- Green off Pilot light ..... J2
- Custom Legend Plate (Specify Legend Markings) ..... NP
- Substitute MCP for Breaker ..... SMCP
- Switching Neutral 4th pole .....S4P
- Switch for Breaker .....SMCS
- Shunt Trip (Specify Voltage Rating)...S87
- Bell Alarm ..... S88

### Electrical Ratings:

- 600V maximum
- 3 poles

Ampere Interrupting Capacity:

- All EIB/EXB enclosures are rated to 10k AIC
- Eaton Type EG Breaker AIC ratings:
  - 240V: 35k AIC
  - 480V: 25k AIC
  - 600V: 18k AIC

### Standard Materials:

- Body & Cover – Copper-free aluminum
- Gasket – Neoprene
- Cover Bolts – Steel
- Hinges – Stainless Steel
- Mounting Plate Sheet – Aluminum

### Ordering Information:

CIRCUIT BREAKER RATING (AMPS)	ENCLOSURE ONLY	ENCLOSURE WITH SWITCH
15	EIBA	EIBA3015
20	EIBA	EIBA3020
25	EIBA	EIBA3025
30	EIBA	EIBA3030
35	EIBA	EIBA3035
40	EIBB	EIBB3040
45	EIBB	EIBB3045
50	EIBB	EIBB3050
60	EIBB	EIBB3060
70	EIBB	EIBB3070
80	EIBB	EIBB3080
90	EIBB	EIBB3090
100	EIBB	EIBB3100
125	EXBC	EXBC3125
150	EXBC	EXBC3150
175	EXBC	EXBC3175
200	EXBC	EXBC3200
400	EXBD	EXBD3400
600	EXBD	EXBD3600
800	EXBE	EXBE3800
1200	EXBF	EXBF31200

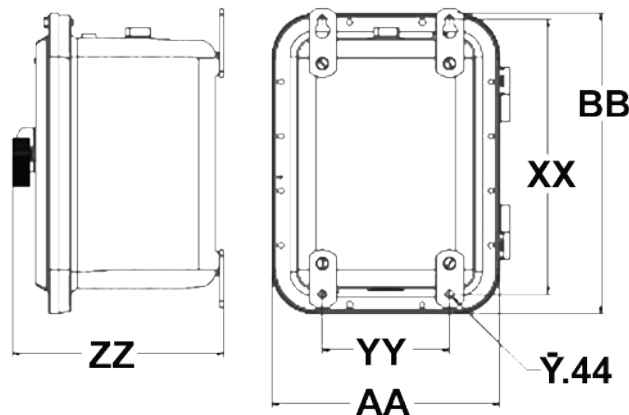





# EXB and EIB

Compact Circuit Breaker Assemblies



## EIBA/EIBB

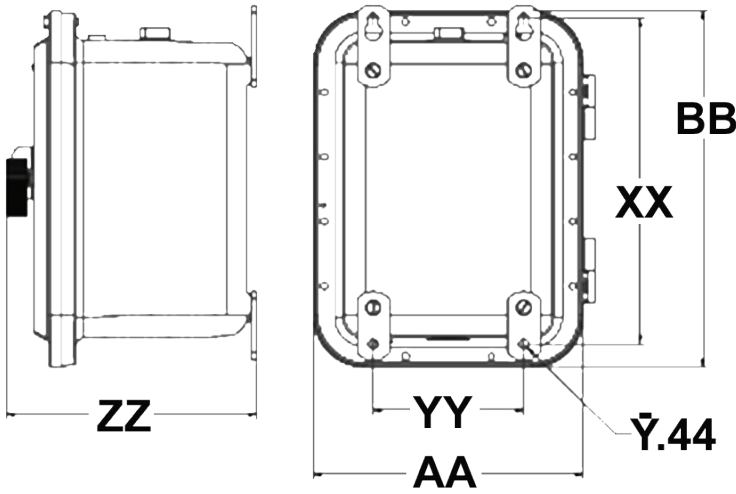

## EXBC/EXBD EXBE/EXBF

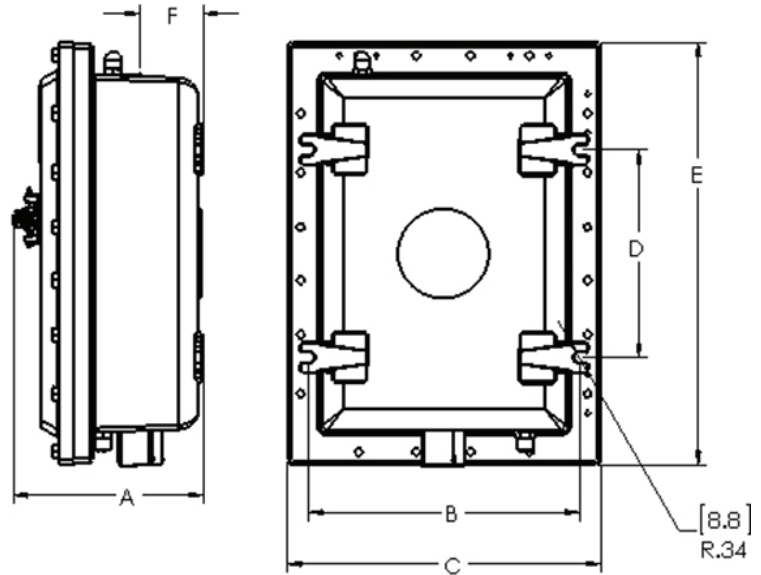

**Green Energy Efficient:** The EXB and EIB circuit breakers by Spike Electric Controls are renowned for their energy-efficient design. These circuit breakers employ cutting-edge technology and precise engineering to minimize energy loss and heat generation during operation. This efficiency not only reduces electricity consumption but also contributes to a longer lifespan of the components, making them a sustainable choice for various electrical applications. Spike Electric Controls' commitment to energy efficiency ensures that their EXB and EIB circuit breakers help customers save energy and reduce operational costs while maintaining reliable performance.

### Dimension and Weights:

DIMENSION	EIBA	EIBB	EXBC	EXBD	EXBE	EXBF
A	9.65"	11.75" (298mm)	13.19" (335mm)	13.49" (343mm)	14.16" (360mm)	14.22" (361mm)
B	5.00"	7.00"	14.94" (380mm)	14.94" (380mm)	22.37" (568mm)	29.69" (754mm)
C	10.47"	12.53" (318mm)	17.44" (443mm)	17.19" (437mm)	23.84" (606mm)	30.11" (765mm)
D	11.13"	15.13" (384mm)	17.50" (445mm)	29.50" (749mm)	28.26" (718mm)	28.30" (719mm)
E	12.47" (317mm)	16.53" (420mm)	29.44" (748mm)	41.22" (1047mm)	41.48" (1063mm)	42.11" (1070mm)
F	2.75"	2.75" (70mm)	5.00" (127mm)	5.00" (127mm)	5.00" (127mm)	5.00" (127mm)
Weights	36 lbs.	62 lbs. (28 kg.)	167 lbs. (76 kg.)	258 lbs. (117 kg.)	355 lbs. (161 kg.)	481 lbs. (218 kg.)
Conduit Size (Top & Bottom)	1.5"	1.5"	3.0"	(2) 3.0"	(2) 4.0"	(3) 4.0"

\*When ordered with S752 or S753 suffix.

\*\*When ordered with S756V suffix.

†For both drains and auxiliary contacts, please contact factory.